



Bronze sculpture of a warrior
(‘Early Classic’ period, c.455 BCE);
‘Kouros’ (c.600 BCE)

‘Niobid Painter,’ scene of Apollo and Artemis slaughtering the children of Niobe (c.455 BCE)





Polykleitos, 'Doryphoros/Spear-Bearer'
(original: 'High Classic' period, c.445 BCE)

Ground plan and aerial view of the 'Acropolis' in Athens (reconstruction: 'High Classic' period, c.400 BCE)

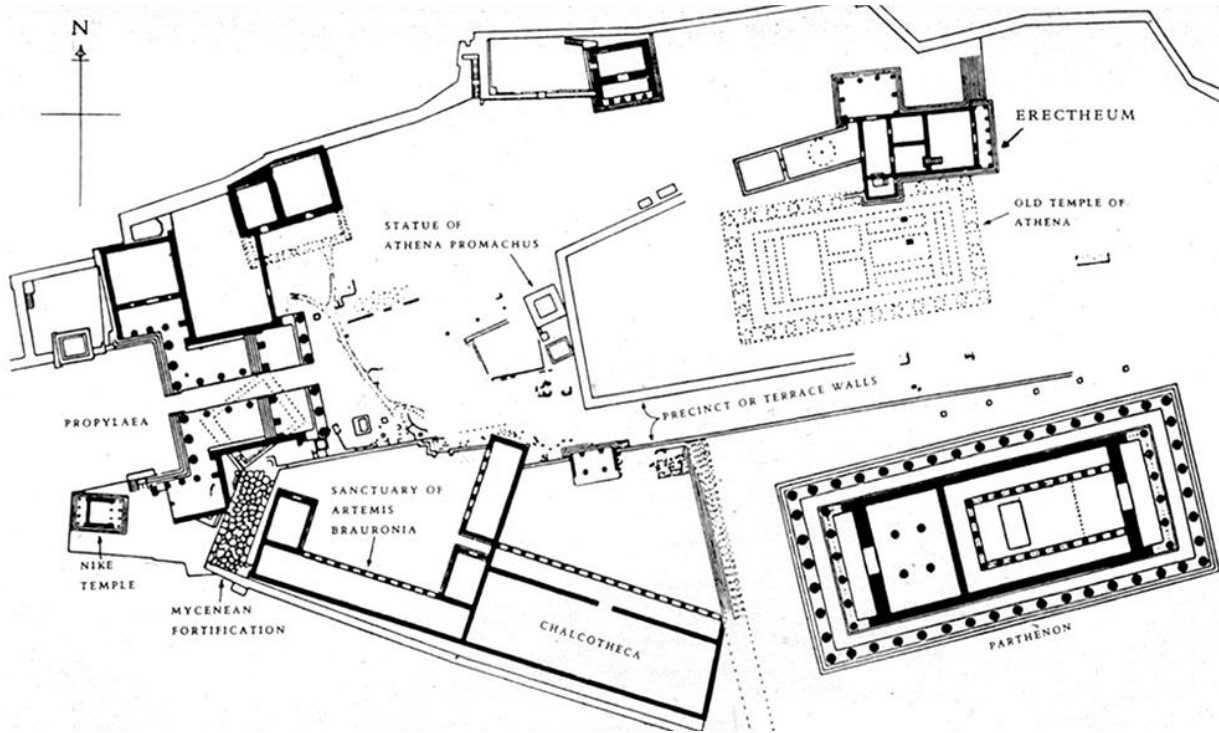



General view and detail of the fortifications of
the 'Acropolis' in Athens



Temple of Athena 'Parthenos'/'Parthenon' (447-432 BCE)





'Parthenon' details (447-432 BCE):
East pediment and 'Doric' frieze, pediment sculpture,
reconstruction of east pediment central group
(*'Birth of Athena'*)





‘Parthenon’ details (447-432 BCE):
West pediment with ‘Doric’ and ‘Ionic’
friezes, ‘Doric’ frieze metope, ‘Ionic’ frieze



‘Parthenon’ details (447-432 BCE): ‘Doric’ frieze metopes depicting ‘Lapiths fighting Centaurs’

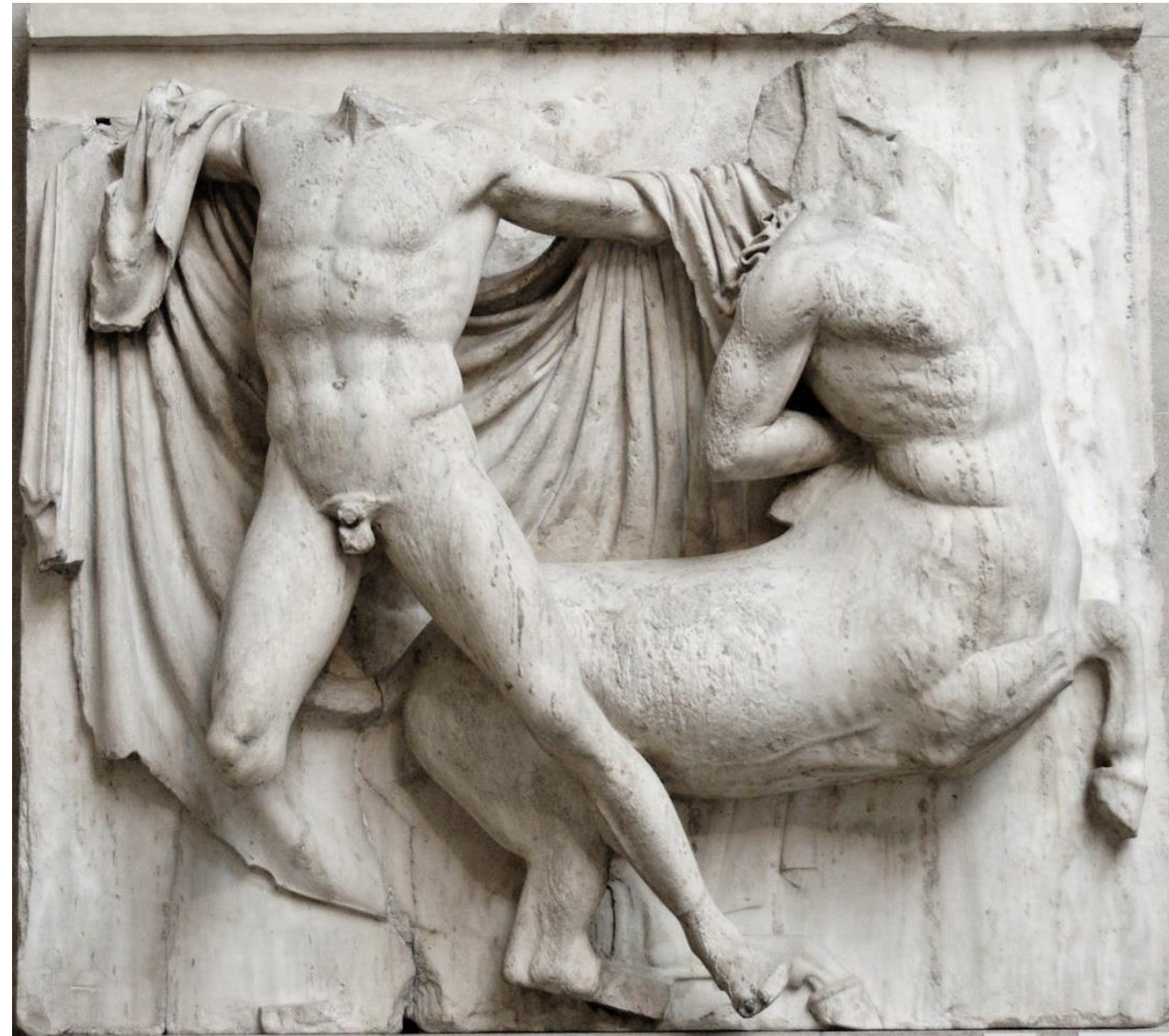
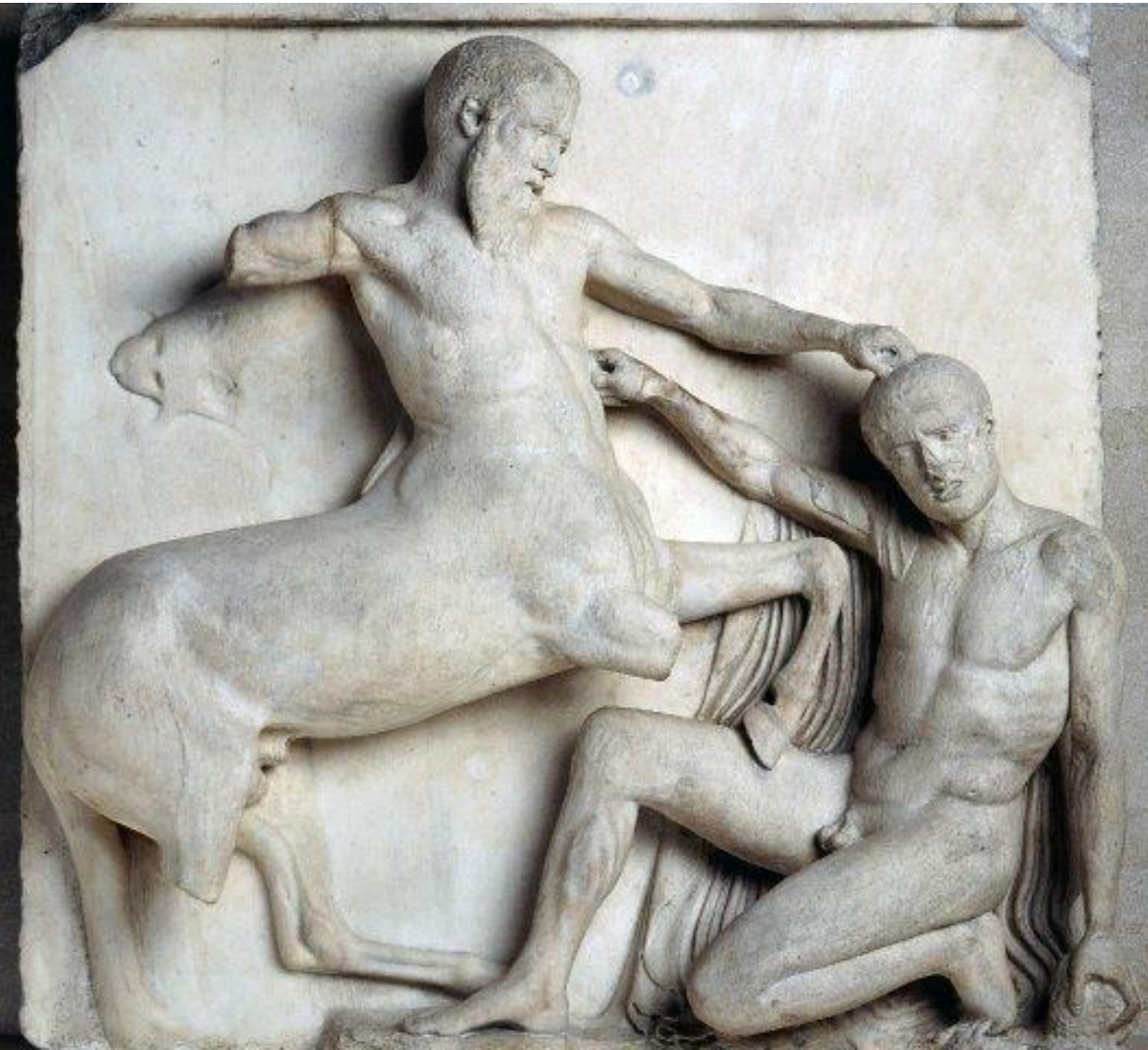

'Parthenon' detail (447-432 BCE): Scene referencing the story of 'Erechtheus' from the 'Ionic' frieze



Temple dedicated to 'Athena Nike' (c.420-405 BCE)





Sculpture depicting 'Nike (personification of victory) adjusting her sandal'
(c.415 BCE)